

XL

Economy Heavy Duty Passthrough Dishwasher W 750mm x D 765mm x H 1530mm

The Washtech XL is a powerful, versatile, simple-to-use and easy-to-maintain passthrough dishwasher. With world class water consumption rates, high performance 1.5HP wash pump, and rapid rinse heating the XL is highly productive, economical to operate and light on the environment.

The XL features Washtech hybrid controls which combine IP65 stainless switches and tried-and-tested switchgear with a customisable electronic timer. In addition it is equipped with a heavy duty stainless steel wash manifold and scrap trays, and is supplied suitable for connection to either single or three phase power supplies.

Since 1981 Washtech dishwashers have been constructed from heavy-duty stainless steel, and are engineered specifically for Australian conditions and regulations. Backed by the most extensive service network and spare parts inventory in the region, your Washtech XL will not let you down.

Standard Features

- 40, 60 and 90 second cycles – autostart upon hood closure
- Capacity of up to 1,620 plates per hour
- Low hot water consumption of 2.4 litres per cycle
- Heavy-duty stainless steel construction
- Heavy-duty stainless steel wash and rinse arms with precision stainless steel jets
- Heavy-duty stainless steel double filtration system with dual scrap trays and separate wash inlet filter
- Washtech hybrid controls
- Easy installation including:
 - Water supply hose
 - Detergent and rinse aid pumps with injector lines
- Watermark approved backflow prevention
- Moffat's comprehensive 5-2-1 Warranty

Includes:

- 2 x 500mm dish rack (600 70028)
- 1 x 500mm cup rack (600 70029)
- 1 x cutlery basket (C660508)
- 1 x cutlery container (C660503)

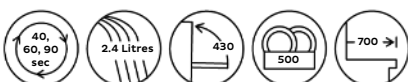

XL



moffat.com.au
washtech.com.au

Moffat Pty Limited

VIC/TAS/SA

70 Springvale Road
Mulgrave, Victoria 3170
Telephone 03-9518 3888
Fax 03-9518 3833
vsales@moffat.com.au

NSW

Telephone 02-8833 4111
nswsales@moffat.com.au

QLD

Telephone 07-3630 8600
qldsales@moffat.com.au

WA

Telephone 08-9413 2400
wasales@moffat.com.au

In line with policy to continually develop and improve its products, Washtech reserves the right to change specifications and design without notice.

© Copyright Moffat Ltd
Version: WXL0030 2104

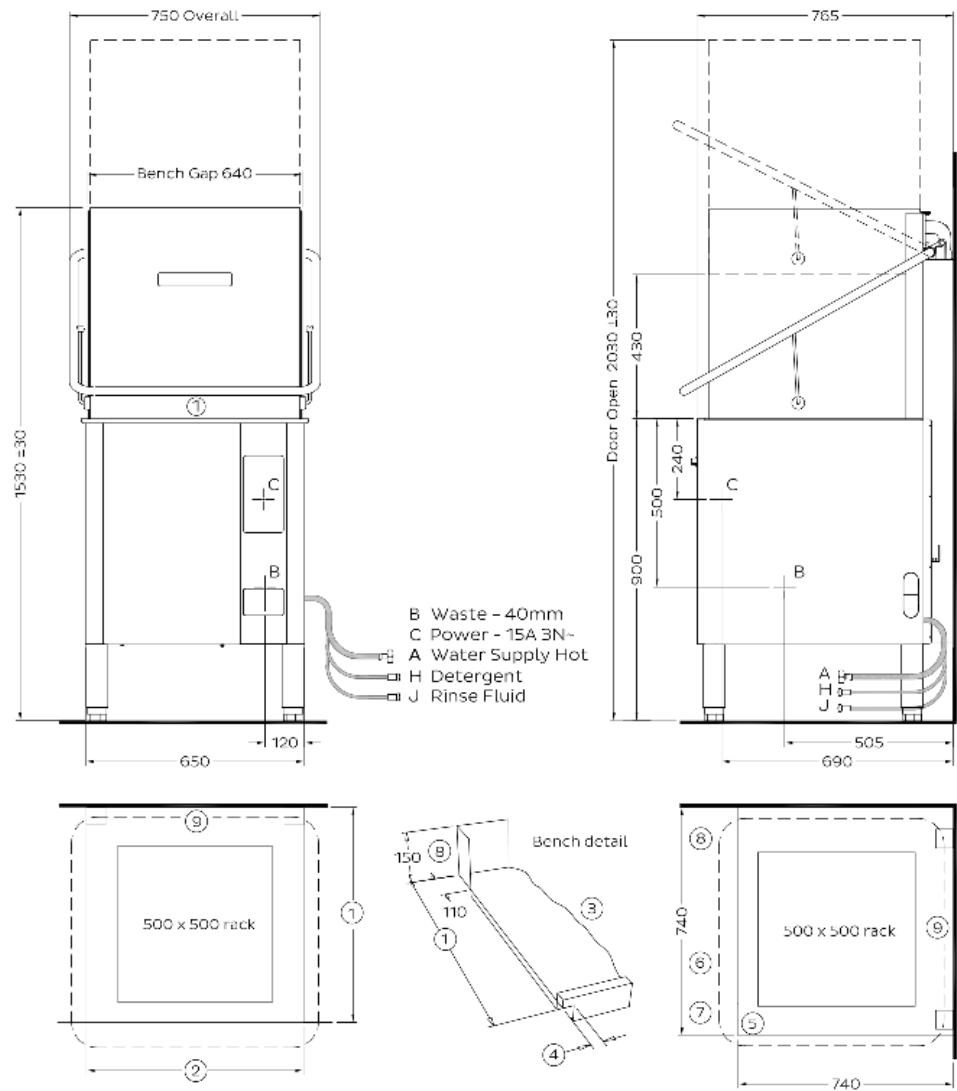

A - Hot Water

Temperature 65°C
Connection 3/4" male; hose supplied
Pressure 200-350kPa
Flow 20 litres per min
Quality Potable - refer table
Backflow Prevention AVB
Consumption 2.4 litres per cycle*

B - Waste

Connection 1.5" BSP
Line 2" BSP

C - Electrical	V	Hz	A/phase	Max kW
Single Phase	240	50	25	6.10
Three Phase	415	50	15	9.00

Dimensions

	Machine	Packed
Width (mm)	750	760
Depth (mm)	765	830
Height (mm)	1530	1450
Weight (kg)	120	141
Volume (m ³)		0.92

Water Quality

	Min	Max
pH	7	8
Hardness (ppm)	20	100
Cl ⁻		100
SO ₄		400
Fe		0.1
Mn		0.5
Cu		0.05
Cl ₂		0.1

Corner Installation Notes

- Machine must face left for easy access to controls
- Allow 300 clearance to front for service access
- Splashback return must be no higher than 150mm

* Water consumption rates may vary based on site conditions.

Isolating switch must be within 1m of, and not directly behind the machine.

Refer to operator manual for installation instructions.



an Ali Group Company

