

M2C

Professional Passthrough Dishwasher with Heat Recovery Unit – 500mm rack
W 705mm x D 720mm x H 2035mm

The Washtech M2C is a powerful and highly efficient passthrough dishwasher that combines the latest technology with heavy duty stainless steel construction and componentry. With economical water consumption rates, integrated heat recovery system and powerful rinse heating, the M2C provides excellent wash results while being light on operating costs and the environment.

The M2C's intuitive electronic controls provide Soft Start, EcoPower, cycle customisation, chemical adjustability and immediate fault diagnosis. The M2C is fitted with a highly efficient heat recovery unit that minimises energy consumption and steam emissions for even lower operating costs and an improved working environment. Capable of fitting into 595-640mm bench gaps, the M2C is the perfect machine for busy restaurants and production kitchens.

Since 1981 Washtech dishwashers have been constructed from heavy-duty stainless steel, and are engineered specifically for Australian conditions and regulations. Backed by the most extensive service network and spare parts inventory in the region, your Washtech M2C will not let you down.

Special Features

- Suitable for installation without an extraction canopy in many situations
- Integrated heat recovery unit reduces steam emissions and energy consumption and optimises cold water operation

Standard Features

- Autostart on hood closure
- 1, 2 and 3 minute cycles
- Capacity of up to 1,080 plates / 1,500 glasses per hour
- Compatible with 500mm racks
- Low water consumption of 2.4 litres per cycle
- Heavy-duty stainless steel construction and wash manifold
- Reliable double filtration system via scrap trays and separate wash inlet filter
- Advanced electronic controls
- Soft start wash cycle
- Easy installation with:
 - Water supply hose
 - Detergent and rinse aid pumps with injector lines
 - Drain pump with outlet hose
- Self-cleaning cycle
- EcoPower - reduced temperatures and energy consumption when machine is idle
- Watermark approved backflow prevention
- Moffat's comprehensive 5-2-1 Warranty

Includes:

- 2 x 500mm dish rack (600 70028)
- 1 x 500mm cup rack (600 70029)
- 2 x cutlery container (C660503)

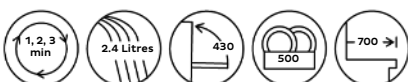

M2C



moffat.com.au
washtech.com.au

Moffat Pty Limited

VIC/TAS/SA

70 Springvale Road
Mulgrave, Victoria 3170
Telephone 03-9518 3888
Fax 03-9518 3833
vsales@moffat.com.au

NSW

Telephone 02-8833 4111
nswsales@moffat.com.au

QLD

Telephone 07-3630 8600
qldsales@moffat.com.au

WA

Telephone 08-9413 2400
wasales@moffat.com.au

In line with policy to continually develop and improve its products, Washtech reserves the right to change specifications and design without notice.

© Copyright Moffat Ltd
Version: WM20023 2101

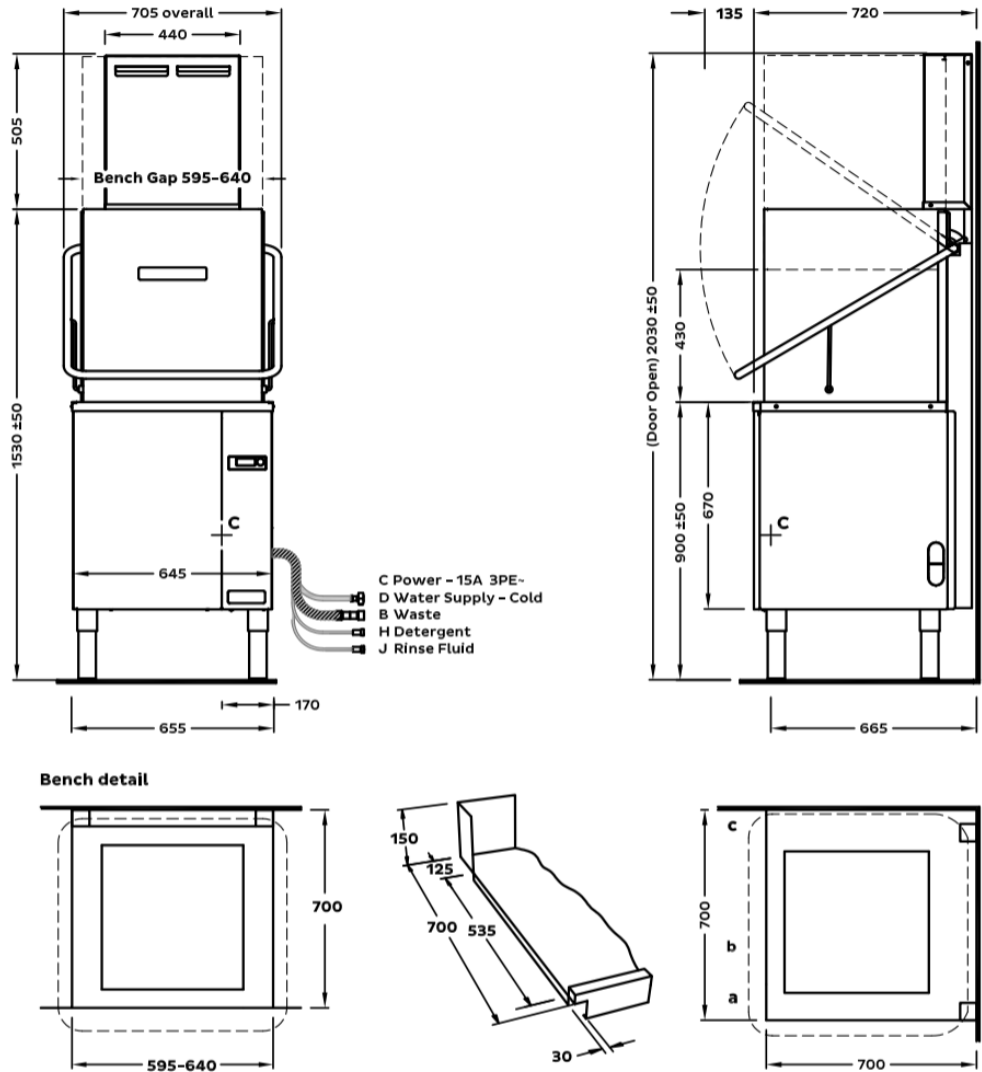

D - Cold Water

Temperature <25°C
Connection 3/4" male; hose supplied
Pressure 100-350kPa
Flow 10 litres per min
Quality Potable - refer table
Backflow Prevention AVB
Consumption 2.4 litres per cycle

B - Waste - Pumped Drain

Connection Hose supplied for open standpipe
750 high or connection to sink trap

C - Electrical	V	Hz	A/phase	Max kW
Three Phase	415	50	15	11.25

Dimensions

	Machine	Packed
Width (mm)	705	755
Depth (mm)	720	765
Height (mm)	2035	2040
Weight (kg)	118	142
Volume (m ³)		1.18

Water Quality

	Min	Max
pH	7	8
Hardness (ppm)	20	100
Cl ⁻		100
SO ₄		400
Fe		0.1
Mn		0.5
Cu		0.05
Cl ₂		0.1

Corner Installation Notes

- Machine must face left for easy access to controls
- Allow 300 clearance to front for service access
- Splashback return must be no higher than 150

Isolating switch must be within 1m of, and not directly behind the machine.

Suitable for installation without extraction canopy in most instances. Full certification from SEED available on request.

Refer to operator manual for installation instructions.