

GE

Economy Compact Glasswasher W 440mm x D 515mm x H 780mm

Washtech's GE is a compact glasswasher ideal for the tightest of locations. The XG features Washtech Hybrid Controls which combine IP65 stainless switches, tried-and-tested switchgear, with a customisable electronic timer.

Since 1981 Washtech dishwashers and glasswashers have been constructed from heavy-duty stainless steel, and are engineered specifically for Australian conditions and regulations. Backed by the most extensive service network and spare parts inventory in the region, your Washtech glasswasher will not let you down.

Standard Features

- Rapid 1 minute glasswashing wash cycle
- Washes up to 540 glasses per hour
- Hot water consumption of 4.5 litres per cycle
- Washtech Hybrid Controls
- Self-cleaning cycle
- Selectable cold rinse
- Easy installation, supplied complete with:
 - Dual water supply hoses (hot & cold)
 - Detergent injector with injector line
 - 15 amp plugset
 - No commissioning required
- Heavy-duty stainless steel construction
- Lower wash/rinse arm with precision moulded jets and an upper rinse jet
- Watermark approved backflow prevention
- Comprehensive 5-2-1 Warranty

Includes:

- 1 x 365mm glass rack (K0401)

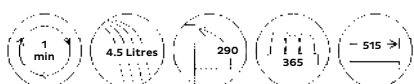

GE

Economy Compact Glasswasher W 440mm x D 515mm x H 780mm

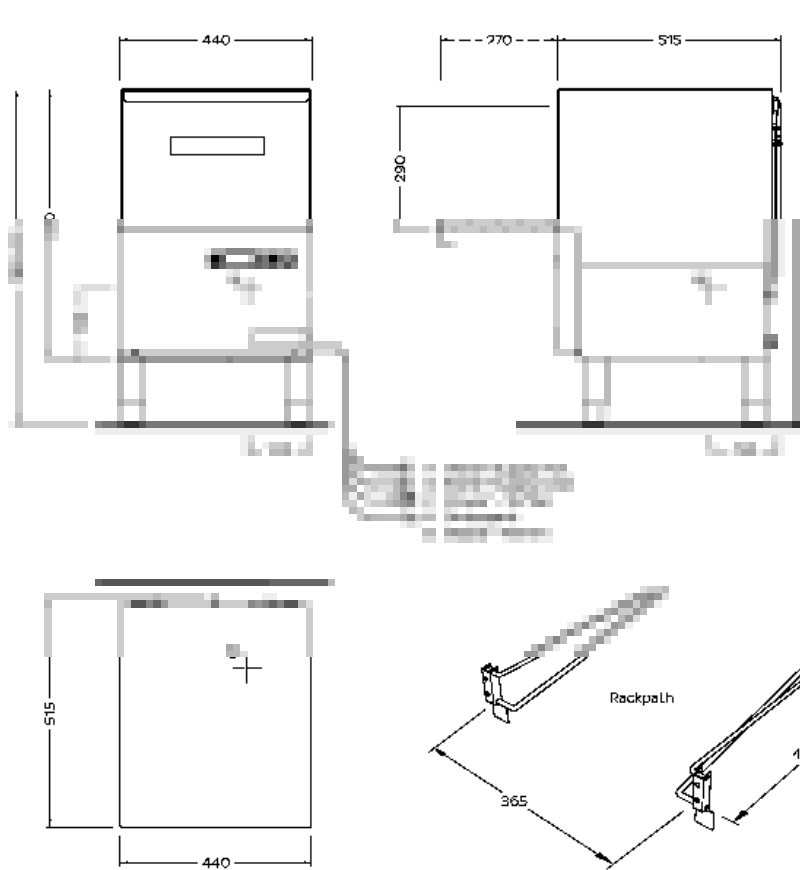

moffat.com.au

Australia
Moffat Pty Limited

Victoria/Tasmania
740 Springvale Road
Mulgrave, Victoria 3170
Telephone 03-9518 3888
Facsimile 03-9158 3833
vsales@moffat.com.au

New South Wales
Telephone 02-8833 4111
nswsales@moffat.com.au

South Australia
Telephone 03-9518 3888
vsales@moffat.com.au

Queensland
Telephone 07-3630 8600
qldsals@moffat.com.au

Western Australia
Telephone 08-9202 6820
wasales@moffat.com.au



ISO9001
All Washtech products are designed and manufactured by Washtech using the internationally recognised ISO9001 quality management system, covering design, manufacture and final inspection, ensuring consistent high quality at all times.

In line with policy to continually develop and improve its products, Washtech reserves the right to change specifications and design without notice.



© Copyright Moffat Ltd
Version: 1903

A Hot water		Dimensions		Machine		Packed	
Temperature	65°C	Width	440	Width	440	Depth	480
Connection	3/4" male; hose supplied	Depth	515	Depth	515	Height	570
Pressure	200-350kPa	Height	780	Height	780	Weight	740
Flow	20 litres per min	Weight	26	Weight	26	Cubicmetres	39
Quality	Potable - refer table						0.2
Backflow Prevention	Atmospheric Vacuum Breaker	Water Quality		Min	Max		
Consumption	4.5 litres per cycle*	pH		7	8		
D Cold water (optional cold rinse)		Hardness ppm		20	100		
Temperature	20°C	CL-			100		
Connection	3/4" male; hose supplied	SO ₄			400		
Pressure	200-350kPa	Fe			0.1		
Flow	20 litres per min	Mn			0.5		
Quality	Potable - refer table	Cu			0.05		
Backflow Prevention	Atmospheric Vacuum Breaker	Cl ₂			0.1		
B Waste							
Connection	1.5" BSP						
Line	2" BSP						
C Electrical		V	Hz	A/phase	max kW		
Single Phase		240	50	15	3		

Refer operator manual for installation instructions. Isolating switch must be within 1m of, and not directly behind the machine.

*Consumption may vary with site conditions.

an Ali Group Company



The Spirit of Excellence