

Infill Benches

C300 300mm Infill Bench

C450 450mm Infill Bench

C600 600mm Infill Bench

C900 900mm Infill Bench

C900-S 900mm Infill Bench with Salamander upstands



C900

- Cobra Series suite matching
- Fully modular
- 4 modular widths
- Salamander upstand model
- Stainless steel finish
- Easy clean
- Flat pack construction



C300



C450



C600



C900-S

OVERALL CONSTRUCTION

Bench Top

- 3.2mm thick compound work surface
- 1.2mm 304 stainless steel top
- 2.0mm galvanised steel backing
- Splashback 0.9mm stainless steel

Leg stand

- Modular for suite matched finish
- 63mm dia. heavy-duty 1.2mm stainless steel legs with adjustable feet
- Framed stand shelf with 1.2mm stainless steel finish
- Quick assembly design (no tools required)*

* except C900-S for assembly of Salamander upstand.

Matching Products



CR9D



CR6C



CF2



C9C



C6D



CP4



CS9 / C900-S



C6B



CT9

Infill Benches

C300 300mm Infill Bench

C450 450mm Infill Bench

C600 600mm Infill Bench

C900 900mm Infill Bench

C900-S 900mm Infill Bench with Salamander upstands

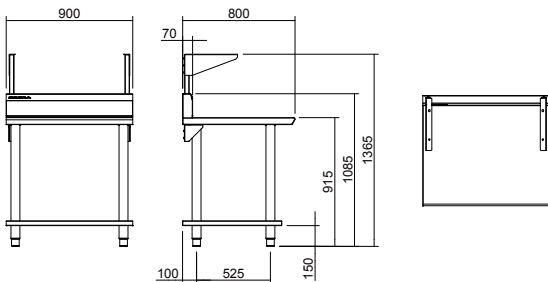
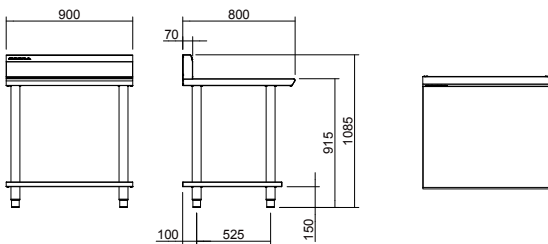
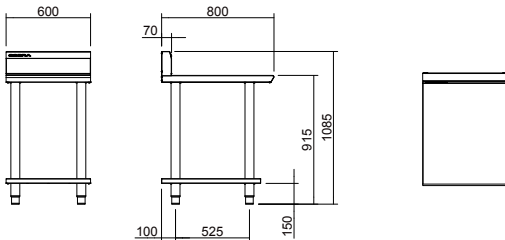
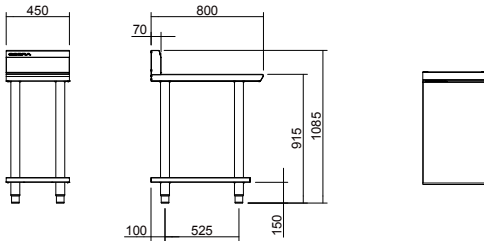
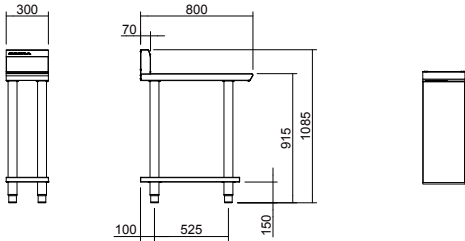

SPECIFICATIONS

Dimensions

All models

Width 300mm, 450mm,
600mm, 900mm

Depth 800mm

Height 915mm

Incl. splashback 1085mm

Nett weight

C300 22.7kg

C450 28kg

C600 33.5kg

C900 44.1kg

C900-S 47.1kg

Packing data

C300 0.103m³, 25.7kg

Width 920mm

Depth 415mm

Height 270mm

C450 0.140m³, 31.7kg

Width 920mm

Depth 565mm

Height 270mm

C600 0.258m³, 49.3kg

Width 920mm

Depth 715mm

Height 270mm

C900 0.355m³, 65.7kg

Width 1015mm

Depth 920mm

Height 380mm

C900-S 0.355m³, 67.7kg

Width 1015mm

Depth 920mm

Height 380mm

moffat.com.au

moffat.co.nz

Australia
moffat.com.au

Moffat Pty Limited

Victoria/Tasmania
740 Springvale Road
Mulgrave, Victoria 3170
Telephone +613-9518 3888
Facsimile +613-9518 3833
vsales@moffat.com.au

New South Wales
Telephone +612-8833 4111
nswsales@moffat.com.au

South Australia
Telephone +613-9518 3888
vsales@moffat.com.au

Queensland
Telephone +617-3630 8600
qldsales@moffat.com.au

Western Australia
Telephone +618-9413 2400
wasaes@moffat.com.au

New Zealand
moffat.co.nz

Moffat Limited

Rollleston
45 Illinois Drive
Izone Business Hub
Rollleston 7675
Telephone +64 3-983 6600
Facsimile +64 3-983 6660
sales@moffat.co.nz

Auckland
Telephone +64 9-574 3150
sales@moffat.co.nz



Designed and manufactured by



ISO9001
All Cobra products are designed and manufactured by Moffat using the internationally recognised ISO9001 quality management system, covering design, manufacture and final inspection, ensuring consistent high quality at all times.

In line with policy to continually develop and improve its products, Moffat Limited reserves the right to change specifications and design without notice.

© Copyright Moffat Ltd
AN.C.01.19 / 1598



Cert. No. AGA 6878G

an Ali Group Company



The Spirit of Excellence