

LOB2UFB

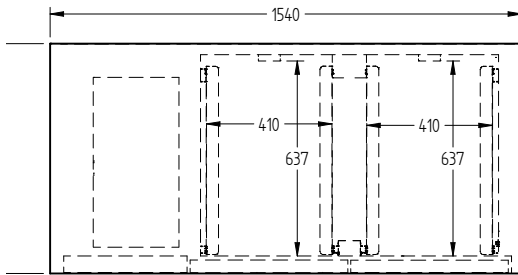

| | |
|----------|----------------|
| CATEGORY | BAKERY |
| RANGE | Opal |
| UNIT | FREEZER |
| TYPE | SELF CONTAINED |
| DOORS | 2 |



TOP VIEW

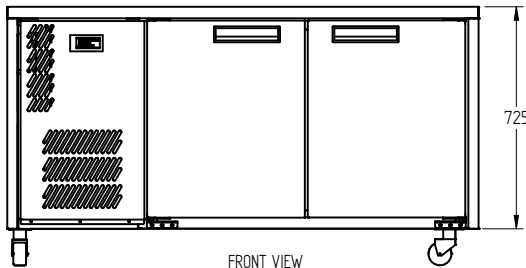

FRONT VIEW

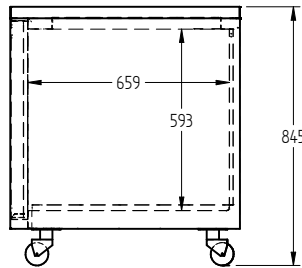

SIDE VIEW

SPECIFICATIONS

| | |
|--|------------------------|
| CAPACITY LITRES | 380 |
| TEMPERATURE | -13°C / -21°C |
| FRONT BREATHING | YES |
| DIMENSIONS - W X D X H (ON CASTORS) MM | 1540 W x 750 D x 845 H |
| WEIGHT UNPACKED (KG) | 150 |

STANDARD INCLUSIONS ***

| | |
|--|---------------------------|
| DOOR TYPE | Standard: SD (Solid Door) |
| FINISH (INTERIOR AND EXTERIOR EXCLUDING REAR AND UNDER) | SS (Stainless Steel) |
| TRAY SLIDES PER DOOR (NO TRAYS OR SHELVES SUPPLIED) (ACCOMMODATES 600 MM X 400MM TRAYS) | 5 |

ELECTRICAL

| | | |
|----------------|--------------|-----|
| POWER SUPPLY | 10 amp | |
| FREEZER MODELS | RUNNING AMPS | 4.5 |

GAS TYPE

| | | |
|-------------|----------------|-------|
| REFRIGERANT | FREEZER MODELS | R404a |
|-------------|----------------|-------|

*** For **OPTIONS** refer to the current Williams Price Guide