

HE3UFBBA



CATEGORY FOODSERVICE COUNTERS

RANGE **EMERALD**

UNIT REFRIGERATOR

TYPE SELF CONTAINED

DOORS 3

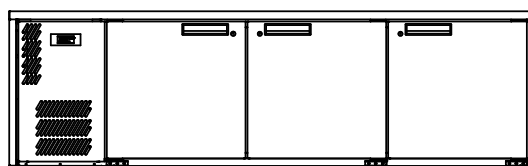
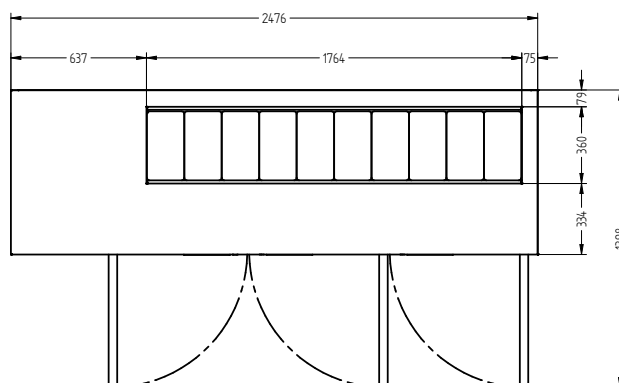
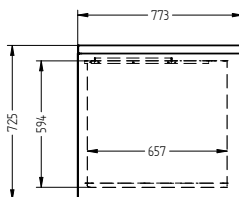

SPECIFICATIONS

| | |
|--|------------------------|
| CAPACITY LITRES | 900 |
| TEMPERATURE | 1°C / 4°C |
| FRONT BREATHING | YES |
| DIMENSIONS - W X D X H (ON CASTORS) MM | 2476 W x 773 D x 845 H |
| WEIGHT UNPACKED (KG) | 200 |

STANDARD INCLUSIONS ***

| | |
|---|---|
| DOOR TYPE | Standard: SD (Solid Door) Optional: DR (Drawer) |
| FINISH (INTERIOR AND EXTERIOR EXCLUDING REAR AND UNDER) | SS (Stainless Steel) |
| SHELVES/DOOR | 1 |
| BLOWN AIRWELL (100MM DEEP 1/3 PANS INCLUDED) | 10 X 1/3 PANS |

ELECTRICAL

| | | |
|----------------------|--------------|--------|
| POWER SUPPLY | | 10 amp |
| BLOWN AIRWELL MODELS | RUNNING AMPS | 4.3 |

GAS TYPE

| | | |
|-------------|---------------|-------|
| REFRIGERANT | FRIDGE MODELS | R134a |
|-------------|---------------|-------|

*** For **OPTIONS** refer to the current Williams Price Guide